



INDUSTRIAL PUMP GROUP

INDUSTRIALPUMPS.NL

INDEX

ABOUT IPG	3
PUMP SALES	6
SEGMENTS	8
APPLICATIONS	9
PUMP REPAIR BY IPG	34
PUMP PARTS	36
PREVENTIVE MAINTENANCE	40
ON-SITE INSPECTION	41
PUMP SCHOOL	42
SUSTAINABILITY AT IPG	44
CERTIFICATIONS	46

ABOUT IPG

In recent years, Industrial Pump Group Nederland BV has evolved as an international player in the pump industry, expanding beyond local markets to a global stage.

Director/owner Frank Korf, along with his brother Robert de Brouwer, recognized the vast opportunities in the global pump market. Leveraging the rich heritage and technical expertise of their family business, dating back to 1962 in IJmuiden, they have successfully steered IPG to international recognition. Originally focused on specialized machinery and pump repairs, the company adapted to the changing technological landscape, now catering to a diverse clientele worldwide.

The strategic shift from a regional focus to a global provider has brought about diversification in IPG’s product offerings and services, committing to innovation and building strong partnerships with suppliers and customers worldwide. This global approach has not only expanded IPG’s market position but has also reinforced the commitment to delivering high-quality, sustainable pump solutions on an international scale.

SALES
Operating independently in the Dutch market, IPG, through extensive collaboration with suppliers, also delivers worldwide. Our sales team, comprising both internal and external services, guides you through pump selection, delivery, and installation.

SERVICE AND REPAIR
Beyond sales, IPG’s service includes post-sale support. Our qualified technicians, available 24/7, offer services domestically and internationally, with a fully equipped workshop ensuring swift and efficient service or repair handling. We also perform customer-specific modifications in our workshop.

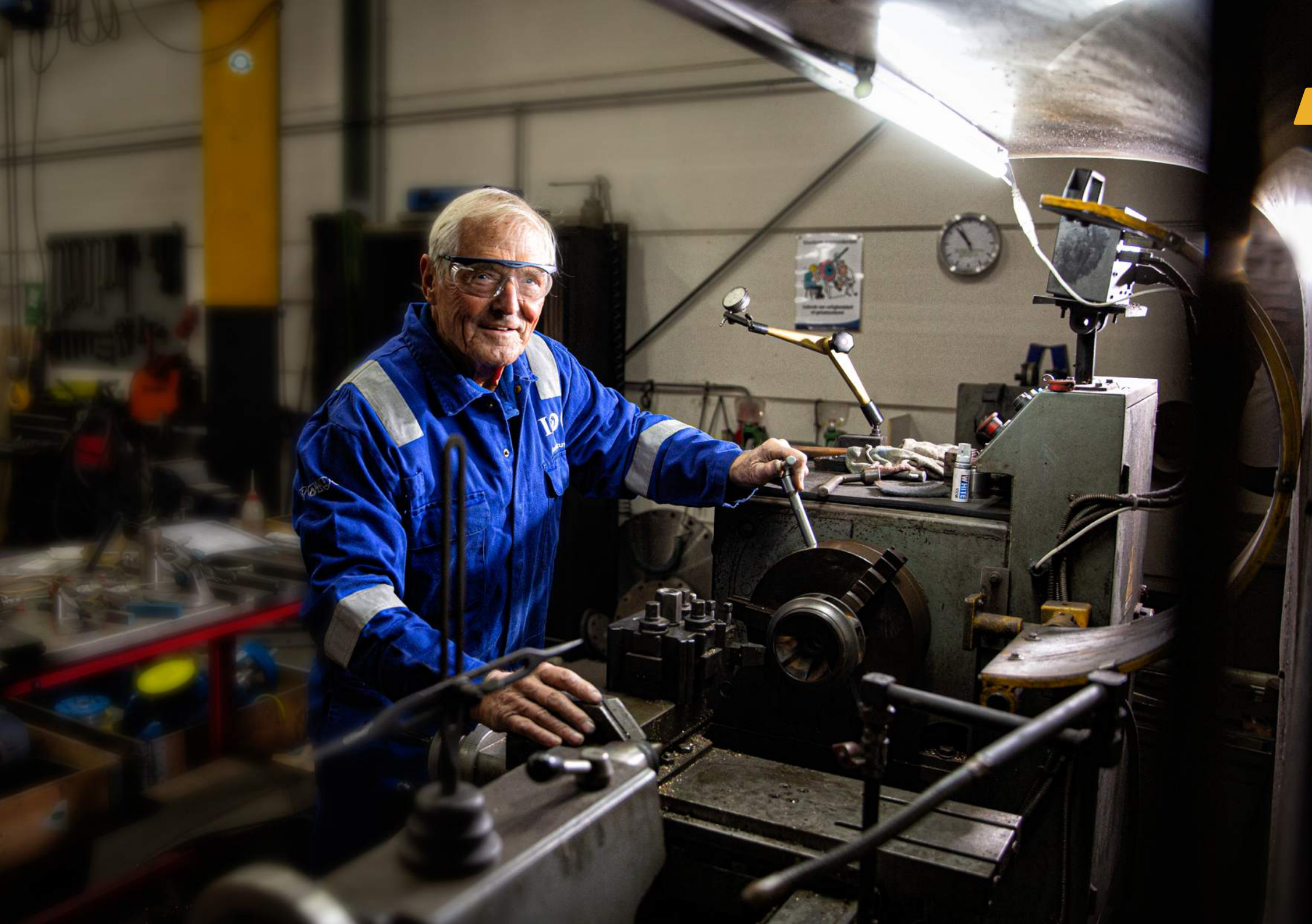

**IPG HAS OVER
35 YEARS OF
EXPERIENCE IN
SUPPLYING,
REPAIRING,
MODIFYING, AND
INSTALLING
ALL BRANDS,
TYPES, AND
SIZES OF PUMPS**

PUMP SALES



YOUR BRAND-INDEPENDENT PARTNER IN PUMP SOLUTIONS

Pumps are the lifeblood of industries, and choosing the right pump is crucial for smooth and efficient processes. At Industrial Pump Group Netherlands B.V. (IPG), we understand that the diversity of pumps and applications makes the selection process complex. As a brand-independent advisor and official dealer of top brands, we aim to provide tailored, independent advice with the goal of building sustainable and long-lasting relationships.

INDEPENDENCE AND GLOBAL DELIVERY

IPG operates as a brand-independent player in the Dutch market, meaning we are not tied to any specific brand. Our commitment to independence allows us to remain critical and only deliver products in which we believe. Although our focus is on the Dutch market, through close collaboration with reliable suppliers, we have the capability to deliver worldwide. With a sales team that includes both inside and outside service, we guide our customers through the entire process, from pump selection to delivery and installation.

DECADES OF EXPERTISE AND COMMITMENT

Since 2003, Industrial Pump Group has served as a partner for companies in search of optimal pump solutions. Our pump experts, with more than 30 years of experience, are ready to advise you, assist with repairs, and sell the right pumps for various industrial applications. Our commitment to your projects goes beyond just supplying pumps; it's about providing customized solutions that meet your specific needs.

SPECIALIZATION IN VARIOUS SECTORS

As a specialist in the field of pumps, we serve a wide range of sectors, including the chemical industry, food industry, steel industry, government, and more. Our website is designed to help you find the most suitable pump based on segment, application, brand, or pump type. Whether it's about providing complete industrial pump systems or revising pump components, IPG guarantees quick delivery, competitive prices, and unparalleled experience in the industry.

CUSTOMIZED SALES AND ADVICE

In the maze of different pump types and applications, the IPG team stands ready to guide you. Whether it involves a submersible, circulation, or well pump, our diverse pump experts offer expert advice to find the best possible solution for your application. We do not only advise but also support you in the purchase and installation of the pump. With strong relationships with various pump manufacturers, including our partnership with SAER and dealership of renowned brands such as Lowara, Grundfos, and Seepex, Industrial Pump Group has the expertise to fulfill your specific pump requirements.

SEGMENTS

Industrial pumps are indispensable devices in numerous sectors and industries. They are used to move, mix, dose, and control liquids and gases. From the food industry to the chemical and petrochemical industry, from water treatment to the oil and gas industry: pumps play a crucial role everywhere.



APPLICATIONS

Industrial pumps can be applied within their segment for various applications.

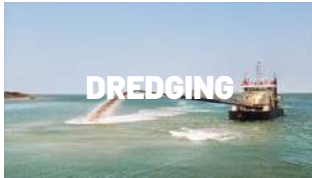

CENTRIFUGAL PUMPS

A centrifugal pump consists of a pump housing containing an impeller that spins around. The principle behind its operation is that the liquid to be pumped is essentially flung outward by the rotating impeller, creating a vacuum (also known as negative pressure) on the inside. This space allows new liquid to flow into the pump, ensuring the continuity of the pump's operation and its function.

Centrifugal pumps can be supplied as standalone units (with or without a motor) as well as complete pump sets.

SEGMENTS: Agriculture, Industry, HVAC, Power Supply, Water Transport, Etc.



MULTISTAGEPUMPS



CLOSE COUPLED PUMPS



SPLITCASE PUMPS



BOREHOLE PUMPS

DO YOU NEED THE RIGHT PUMP? IPG IS READY TO ASSIST YOU!
Feel free to contact our pump experts for expert advice and solutions.
Call +31(0)251 - 222 566 or email info@industrialpumps.nl.

CLOSE-COUPLED PUMPS

Close-coupled pumps are a popular and efficient method for pumping water. Utilizing a single cylinder, these pumps boast a compact design, making them straightforward to install and maintain. Additionally, they are more energy-efficient compared to many other pump types, positioning them as the ideal option for applications necessitating the elevation of water to significant heights.

SEGMENTS: Agriculture, Chemical industry, Metal industry, Water transport



SAER



LOWARA



EBARA



GRUNDFOS

LOOKING FOR THE RIGHT PUMP FOR YOUR APPLICATION?
Contact IPG without obligation; our pump experts are ready to assist.
Call +31(0)251 - 222 566 or email info@industrialpumps.nl
for expert advice and customized solutions.

BOREHOLE PUMPS

Borehole pumps play a critical role in various industries and applications where the extraction of water or other fluids from deep underground sources is necessary. These pumps are specifically designed to operate in boreholes, wells, or deep shafts, making them essential for tasks such as groundwater extraction, oil and gas production, mining operations, and geothermal energy extraction. In this global overview, we'll delve into the working principles, design features, applications, and benefits of borehole pumps.

SEGMENTS: Agriculture, Domestic, Offshore, Water transport



FOR THE RIGHT PUMP THAT SUITS YOUR NEEDS, CONTACT IPG.

Our pump experts are available for free advice.
Call +31(0)251 - 222 566 or email info@industrialpumps.nl.

MULTISTAGE PUMPS

Multistage centrifugal pumps, comprising several stages with centrifugal impellers and diffusers, are designed for high-pressure applications, with options for horizontal or vertical installation and various materials for impellers and seals. The selection of the most suitable pump depends on system parameters like flow rate and medium composition, and we are here to assist you in making the right choice.

SEGMENTS: Oil and gas industry, HVAC, Metal industry, Paper industry, Power supply



LOWARA



SAER



GRUNDFOS

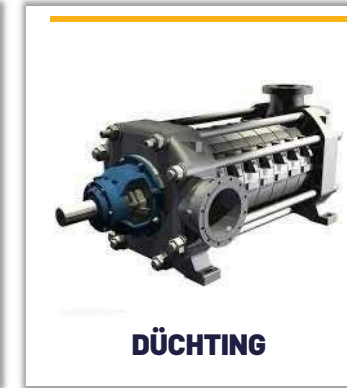

DÜCHTING

ARE YOU SEARCHING FOR THE SUITABLE PUMP FOR YOUR APPLICATION?

Don't hesitate to contact IPG without obligation,
where our experienced pump experts are ready to guide you.
Call +31(0)251 - 222 566 or email info@industrialpumps.nl.

API PUMPS

API specifications are crucial for pumps in the oil and gas industry, where reliability, safety, and performance are paramount. The American Petroleum Institute (API) has established strict requirements, including construction, materials, dimensions, performance criteria, testing requirements, and certifications for suitability in this sector. Compliance with these specifications ensures high reliability and safety, minimizing malfunctions and safety risks. This also promotes optimal performance and efficiency, leading to lower operating costs and an extended lifespan of the pump.

SEGMENTS: Chemical industry, Oil and gas industry, Power supply



HANDOL



NETZSCH



SULZER

IN NEED OF THE RIGHT PUMP FOR YOUR APPLICATION?
Contact IPG without obligation; our pump experts are ready to assist you.
Call +31 (0)251 - 222 566 or email info@industrialpumps.nl.
We provide expert advice and solutions for all your pump support needs.

CHEMICAL STANDARD (ISO 5199) PUMPS

The Chemical Standard ISO 5199 for pumps is an international standard developed to ensure that chemical pumps operate safely and reliably. The standard specifies the requirements for the design, performance, and dimensions of pumps used for pumping chemical fluids, among others.

Manufacturers producing chemical pumps must meet the ISO 5199 standard to sell their products in various markets worldwide. This guarantees that customers purchase reliable and safe pumps that comply with international standards.

SEGMENTS: Industry



LOWARA / XYLEM



SULZER



GRUNDFOS



KSB

DO YOU NEED HELP CHOOSING THE RIGHT PUMP?
IPG's pump experts offer free advice and tailored solutions.
Contact us at +31 (0)251 - 222 566 or info@industrialpumps.nl.

SUBMERSIBLE PUMPS

Submersible pumps are powerful pumps that are submerged in water to pump it efficiently and effectively. They are widely used for pumping wastewater and sewage but are also suitable for domestic use, such as draining a basement or swimming pool. Submersible pumps come in various designs and power levels, depending on the application and the type of water to be pumped. They are generally very reliable and can pump large quantities of water in a short time. When choosing a submersible pump, it's important to consider factors such as the volume of water to be pumped, the maximum lifting height, and the desired pumping speed.

SEGMENTS: Agriculture, Domestic, Water treatment, Water transport



LOWARA



FLYGT

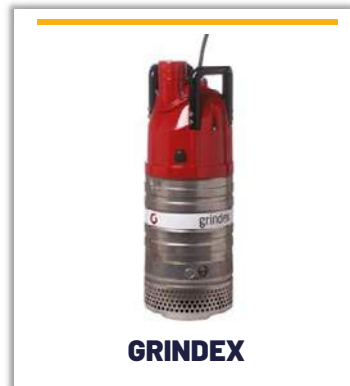

GRINDEX



HOMA

LOOKING FOR EXPERT ADVICE FOR YOUR PUMP NEEDS?

Industrial Pump Group is here for you!

Feel free to contact us at +31(0)251 - 222 566 or info@industrialpumps.nl.

END-SUCTION PUMPS

End-suction pumps are a commonly used type of pumps utilized for transporting liquids in various industries. With a simple design and user-friendly installation, end-suction pumps are an efficient and reliable solution for fluid transportation.

An end-suction pump is composed of a suction inlet, an impeller, and a discharge channel. The impeller draws the medium into the suction inlet and then propels it through the discharge channel to the outlet. This process increases the pressure of the medium, allowing it to be transported further.

SEGMENTS: Agriculture, Chemical industry, Metal industry, Water transport



LOWARA



SAER



GRUNDFOS



EBARA

FOR THE PERFECT PUMP SOLUTION, CONTACT IPG.

Our pump experts offer free assistance.

Call +31(0)251 - 222 566 or email info@industrialpumps.nl.

MIXED FLOW PUMPS

Mixed flow pumps are designed to move large volumes of water at relatively low pressures. These pumps are widely used across various industries, including agriculture, construction, water treatment, HVAC, and fire protection. Thanks to their unique design, mixed flow pumps offer a combination of high efficiency and performance, making them a cost-effective and sustainable solution for water displacement. From irrigation to drainage systems, these pumps can be tailored to various applications and provide reliable and efficient performance. Choosing the right mixed flow pump for a specific application is crucial to ensure optimal performance and minimize energy costs.

SEGMENTS: Agriculture, HVAC, Water treatment, Water transport



IN NEED OF CUSTOMIZED SOLUTIONS FOR YOUR PUMP CHALLENGE?

IPG is here for you!

Feel free to contact us at +31 (0)251 - 222 566 or info@industrialpumps.nl.

SPLITCASE PUMPS

Splitcase pumps are centrifugal pumps used for pumping large volumes of liquids in various industries and applications. They are suitable for high-capacity and high-pressure applications and are often used in water treatment, irrigation, fire fighting, chemical production, the petrochemical industry, the paper and pulp industry, and mining. The design of splitcase pumps allows the pump to be split into two halves, making maintenance simpler. These pumps also offer higher efficiency, lower maintenance costs, and reduced vibrations. Splitcase pumps can be powered by electric motors or diesel engines and can be supplied with various materials and coatings, depending on the application.

SEGMENTS: Industry, Power supply

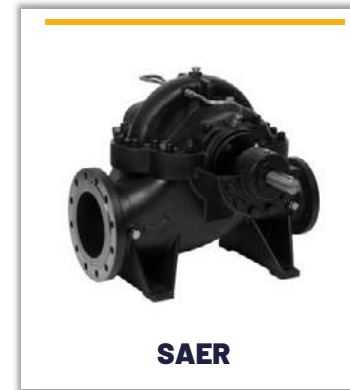

SAER



FLYGT



SULZER



HANDOL

DO YOU NEED HELP CHOOSING THE RIGHT PUMP?

Our pump experts offer free advice and tailored solutions.

Call +31 (0)251 - 222 566 or email info@industrialpumps.nl.

SLURRY PUMPS

Slurry pumps are heavy-duty industrial pumps designed to transport fluids with high density and hard particles, known as slurry. These pumps are commonly used in mining, cement production, wastewater treatment, and other processes where hard and abrasive substances are transported.

SEGMENTS: Industry, Dredging



DÜCHTING



METSO OUTOTEC



SULZER



GRINDEX

FOR THE PERFECT PUMP SOLUTION, TRUST IPG!

Our expert pump specialists offer free support.
Call +31 (0)251 - 222 566 or email info@industrialpumps.nl.

VERTICAL TURBINE PUMPS

Vertical turbine pumps are used for pumping fluids from deep wells or sources. These pumps have a vertical shaft and impeller, making them efficient and reliable. This guide provides an in-depth insight into the operation of vertical turbine pumps, their applications, and benefits. It also discusses the different types of vertical turbine pumps, their construction, and the selection criteria for choosing the right pump for a specific application.

SEGMENTS: Industry, Power supply



FLYGT



SULZER

LOOKING FOR THE IDEAL PUMP FOR YOUR APPLICATION?

Contact IPG for expert advice and customized solutions.
Call +31 (0)251 - 222 566 or email info@industrialpumps.nl
for a free quote.

IMMERSION PUMP

Immersion pumps, a type of centrifugal pumps, are designed to be placed in wells or reservoirs to pump water upwards. These pumps are highly reliable and efficient, widely used in water supply, irrigation, and industrial applications.

Immersion pumps come in various sizes and materials, depending on the application and the composition of the medium to be pumped. They can also be equipped with different types of motors, such as electric, diesel, or hydraulic motors.

SEGMENTS: Industry, Powerplants, Water treatment



LOWARA



GRUNDFOS



DEBEM



SULZER

FOR THE PERFECT PUMP CHOICE, RELY ON IPG!

Our expert pump specialists offer free support.
Call +31 (0)251 - 222 566 or email info@industrialpumps.nl.

INLINE PUMPS

Inline pumps are centrifugal pumps designed to move liquids in a straight line, with the inlet and outlet on the same line. Unlike traditional pumps with curved inlet and outlet pipes, inline pumps are installed directly in the pipeline, making them easier to mount and maintain.

Inline pumps are widely used in industrial applications such as water treatment, chemical processing, and HVAC systems. Due to their simple installation, high reliability, and efficiency, they are a popular choice for moving large volumes of liquid in various industries.

SEGMENTS: HVAC, Industry, Water transport



SAER



LOWARA



GRUNDFOS

DO YOU NEED THE RIGHT PUMP FOR YOUR APPLICATION?

IPG offers free expert advice and customized solutions.
Call +31 (0)251 - 222 566 or email info@industrialpumps.nl.

PRESSURE BOOSTER SETS

Pressure booster sets are pump systems utilized to regulate and increase water pressure within buildings. Comprising a pump, a pressure vessel, and an automated control system, these sets activate the pump to fill the pressure vessel when water pressure falls below a designated level. Once filled, the pump shuts off, allowing the building to use the water without experiencing a drop in pressure.

SEGMENTS: HVAC, Water transport



SAER



LOWARA



GRUNDFOS

IPG, YOUR RELIABLE SOURCE FOR PUMP ADVICE AND SOLUTIONS!

Feel free to contact us at +31 (0)251 - 222 566 or info@industrialpumps.nl for expert support.

LEAK-FREE PUMPS

Leak-free pumps, such as canned motor or magnetically driven pumps, are a revolutionary solution for the safe and efficient transport of hazardous liquids, including flammable, explosive, and toxic substances. Unlike traditional pumps that require separate sealing and shaft sealing, the canned motor pump incorporates everything into one integrated system. This significantly reduces the risk of leaks and accidents.

SEGMENTS: Chemical industry, Oil and gas industry



LOOKING FOR THE IDEAL PUMP FOR YOUR APPLICATION?

IPG offers free expert advice and solutions. Contact us at +31 (0)251 - 222 566 or info@industrialpumps.nl.

LOBE PUMPS

Lobe pumps are a type of positive displacement pump used for moving fluids. They are often chosen for their excellent capabilities and performance across a variety of applications. The unique construction of lobe pumps makes them particularly suitable for moving high-viscosity fluids and for pumping fluids contaminated with clots or particles.

SEGMENTS: Farmaceutische industry, Food industry, Paper industry

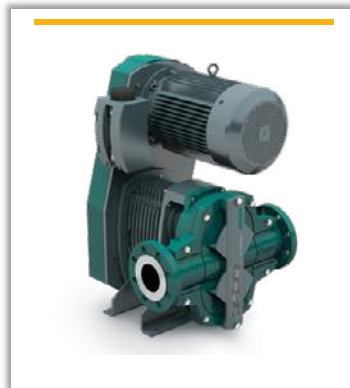

NEED THE RIGHT PUMP?

IPG's pump experts offer free advice and tailored solutions.
Call +31 (0)251 - 222 566 or email info@industrialpumps.nl.

PROGRESSIVE CAVITY PUMPS

Progressive cavity pumps, also known as worm pumps, are a type of positive displacement pump used to move viscous and thick fluids. They are ideal for applications where centrifugal pumps are not effective, such as in moving honey, paint, toothpaste, or even liquid manure.

Overall, progressive cavity pumps provide a reliable and cost-effective solution for moving thick fluids across various applications and industries.

SEGMENTS: Chemical industry, Food industry, Paper industry, Water treatment



SEEPEX



NETZSCH

IPG, YOUR PARTNER IN WORM PUMP ADVICE!

Feel free to contact us for expert customized advice.
Call +31 (0)251 - 222 566 or email info@industrialpumps.nl.

DIAPHRAGM PUMPS

Diaphragm pumps are a crucial component of modern water treatment systems and are used worldwide for a wide range of applications, from agricultural and industrial water treatment to domestic use. These pumps operate using membrane technology and are designed to move water efficiently and sustainably while simultaneously improving water quality.

SEGMENTS: Chemical industry, Farmaceutische industry, Food industry



FOR THE OPTIMAL PUMP SELECTION, CONTACT IPG.

Our expert pump specialists offer free support.
Call +31 (0)251 - 222 566 or email info@industrialpumps.nl.

MIXERS & PROPELLERS

Mixers and propellers are two key components of the water treatment process, essential for producing clean and safe drinking water. Mixers ensure an even distribution of chemicals in the water, such as chlorine for disinfection and lime for pH adjustment, ensuring that chemicals work optimally and are evenly distributed. Propellers are responsible for removing sediments from the water, like sand and silt, before the water is purified. This process reduces the load on filters and increases the efficiency of the treatment process. In summary, mixers and propellers play a crucial role in delivering clean and safe drinking water to consumers.

SEGMENTS: Water treatment

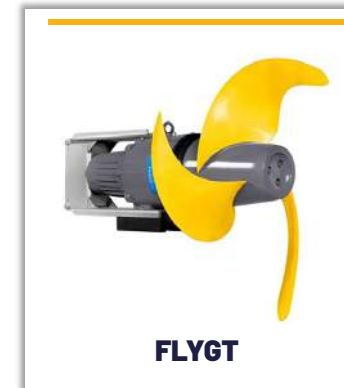

FLYGT



GRUNDFOS

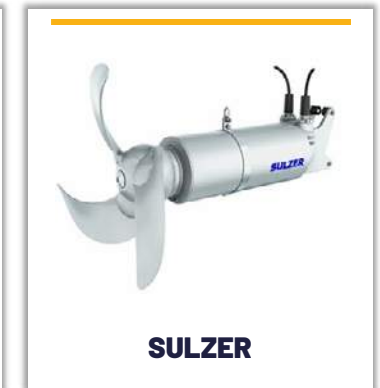

SULZER

LOOKING FOR THE IDEAL MIXER FOR YOUR APPLICATION?

Feel free to contact IPG for expert and brand-independent advice.
Call +31 (0)251 - 222 566 or email info@industrialpumps.nl.

THERMOPLASTIC PUMPS

Thermoplastic pumps are designed for corrosive and abrasive applications in the industry. These pumps are made from chemically resistant materials such as polypropylene, PVC, PVDF, Teflon, and other polymers, making them resistant to corrosion, heat, and chemical attacks. Additionally, they are lightweight, easy to install, and require minimal maintenance. Thermoplastic pumps are commonly used in the chemical, pharmaceutical, and food industries, as well as in water treatment and the electroplating industry. Thanks to their reliability, efficiency, and durability, thermoplastic pumps are a vital component in many industrial applications.

SEGMENTS: Chemical industry, Farmaceutische industry



LOOKING FOR THE IDEAL PLASTIC PUMP FOR YOUR APPLICATION?

We are here to assist you with expert advice and tailored solutions.
Call +31 (0)251 - 222 566 or email info@industrialpumps.nl.

HOSE PUMPS

Hose pumps, also known as peristaltic pumps, are robust industrial pumps designed for pumping fluids with a high particle content and high viscosity. These pumps operate on a unique principle where a flexible hose is compressed and relaxed by a rotating roller or shoes, propelling the fluid forward.

SEGMENTS: Industry

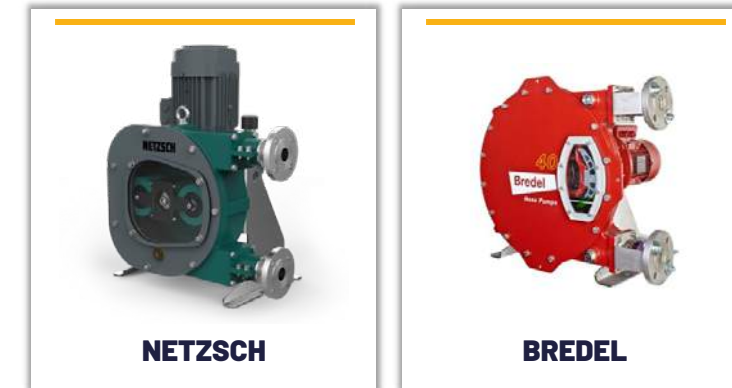

IN NEED OF THE RIGHT PUMP FOR YOUR APPLICATION?

IPG offers free expert advice and customized solutions.
Call +31 (0)251 - 222 566 or email info@industrialpumps.nl.

TOTAL PUMP UNITS

AND MUCH MORE...

Total pump units are a popular alternative to traditional pumps because they offer several advantages, including efficiency, reliability, and easy maintenance. These complete pump systems are designed to enhance the integrity and performance of industrial processes and provide an integrated solution for pumping liquids and gases. By utilizing a total solution, companies can save costs on purchasing and maintaining individual components and increase operational efficiency. Total pump units are suitable for a wide range of applications, including water treatment, the food and beverage industry, petrochemistry, and more.

SEGMENTS: Industry



IN NEED OF COMPLETE PUMP UNITS FOR YOUR NEEDS?

IPG provides expert advice and customized solutions.
Call +31(0)251 - 222 566 or email info@industrialpumps.nl.



IPG IS THE PLACE FOR THE PERFECT PUMP!

Our pump experts are ready to assist you without obligation.
Call +31(0)251 - 222 566 or send an email to info@industrialpumps.nl.

PUMP REPAIR BY IPG



PUMP REPAIR BY OUR SPECIALISTS

IPG's commitment to excellence in pump repair is reflected in our teams of specialists, some of whom have over 30 years of experience in the field. Our skilled technicians are at the core of our repair process, employing craftsmanship and innovative techniques to optimize the performance of your pumps. Whether repairs are carried out in our workshops or on-site, IPG guarantees a thorough and professional approach to your repair needs.

UP-TO-DATE KNOWLEDGE AND COLLABORATION WITH MANUFACTURERS

Our technicians are not only seasoned experts, but they also stay abreast of the latest industry developments. IPG maintains close ties with various manufacturers, enabling our technicians to be regularly trained and their knowledge refreshed. This synergy between experience and current knowledge allows us to apply the most advanced repair techniques and ensure you receive top-quality repair services.

CUSTOMIZATION AND FLEXIBILITY IN REPAIR OPTIONS

With IPG's flexibility, a wide range of repair possibilities is available to meet your specific needs. Whether it involves a complete repair, replacement of several parts, or rewinding a motor, IPG provides a tailored solution. Our repair teams ensure your pumps perform like new, minimizing unplanned downtime.

SUSTAINABLE AND CIRCULAR MAINTENANCE

IPG's approach to pump repair focuses not only on optimizing performance but also on sustainability and circularity. Instead of purchasing new pumps, our sustainable and circular pump repair offers an environmentally conscious solution by refurbishing and reusing existing pumps. This results in cost savings for your company and a significant reduction in waste and CO2 emissions.

YOUR SUSTAINABLE PARTNER FOR PUMP REPAIR

At IPG, sustainability goes beyond pump repair. Our company premises are completely CO2-neutral, with 2350 solar panels generating our own renewable energy. By choosing IPG, you are not only opting for high-quality pump repair but also for a partner that integrates sustainability into every aspect of its operations.

PUMP PARTS

Repair and maintenance of your pump are important, for which you sometimes need new pump parts. You may not always think about this when your pump is running properly. However, without regular checks and maintenance, the pump can malfunction, which can affect your processes.

For maintenance and repair of the pump, you sometimes need spare parts. Whether you need a single O-ring, impeller, or a complete pump part, IPG is the supplier for your pump parts. Thanks to strong relationships with many manufacturers, Industrial Pump Group can provide you with parts for various brands.

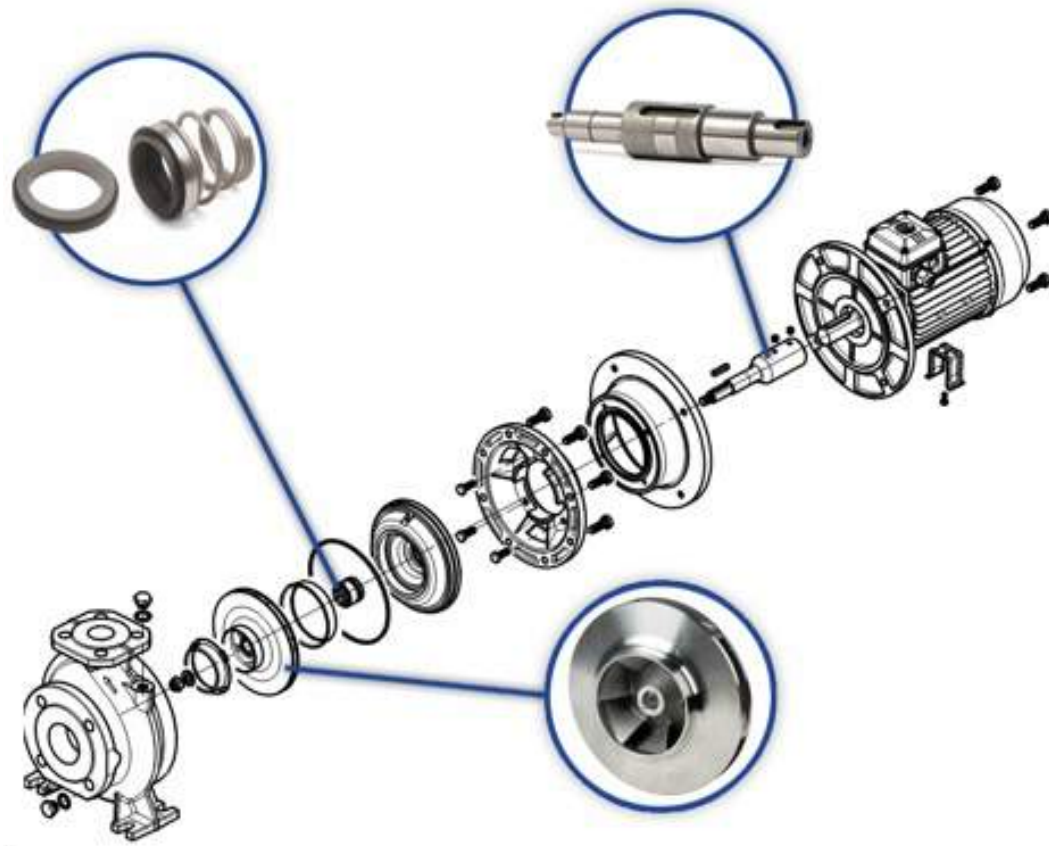

REPAIR OPTIONS

IPG stands out with comprehensive repair services, tailored to various pump types and industrial needs. Our expertise includes, but is not limited to, the following pumps: API pumps, boiler feed pumps, chemical standard pumps, cooling water pumps, plastic pumps, mixed flow pumps, split case pumps, gearboxes, vertical turbine pumps, water standard pumps, progressive cavity pumps, and much more.

IPG offers customized solutions for sustainable pump optimization, making your installations more efficient, reliable, and environmentally friendly. Repairs are never the same and are always performed for each specific pump.

Each repair process at IPG is approached with precision and attention to detail, ensuring that every pump not only meets but exceeds the original performance specifications. This meticulous process involves a thorough analysis of the pump's condition, identifying wear and potential failure points, and replacing or refurbishing parts as necessary with high-quality components. By choosing IPG for your pump repair needs, you gain access to our deep well of knowledge and experience, ensuring that your pumping systems are optimized for peak performance and longevity. This dedication to excellence and sustainability in our repair practices helps in conserving resources and reducing operational costs, making IPG your partner in achieving both your operational and environmental goals.

MULTISTAGE PUMP BEFORE & AFTER REPAIR



PREVENTIVE MAINTENANCE

Prevent downtime, increase efficiency, and extend the lifespan of your pumps with preventive maintenance. Regular inspection, cleaning, and timely replacement of parts are crucial to avoid malfunctions and reduce total costs.

A CRUCIAL INVESTMENT IN PUMP SUSTAINABILITY

Preventive maintenance is key to a longer lifespan and optimal operation of your pumps. IPG offers customized maintenance plans tailored to your specific pump and piping systems. Our experienced technicians perform thorough inspections, identify potential issues, and provide timely solutions to prevent costly repairs and unplanned downtime.

SUSTAINABILITY AND EFFICIENCY

In addition to extending the life of your pumps, preventive maintenance contributes to improved operational efficiency and lower energy costs. IPG guarantees high-quality preventive maintenance that not only protects your investment but also contributes to more sustainable operations.

IPG'S COMMITMENT TO SUSTAINABILITY AND CIRCULAR THINKING

At IPG, sustainability is a priority. Our circular approach to pump repair and preventive maintenance aligns with our commitment to a greener future. Through material reuse, CO2-neutral operations, and minimizing our ecological footprint, we offer not just high-quality pump services but also a sustainable partner in every aspect of our service offering.



ON-SITE INSPECTION

The Industrial Pump Group (IPG) offers comprehensive on-site inspection services to assess the integrity of your pump and piping systems. Our experienced technicians perform visual inspections and use advanced technologies to detect potential issues in your system. By analyzing the inspection results, we can then make recommendations for maintenance or repair work to improve the efficiency and reliability of your system and minimize downtime.

ON-SITE INSPECTION AND MAINTENANCE

To prevent downtime and potential damage to a (pump) installation, preventive maintenance is important. However, sometimes pump failure is unavoidable. In either case, IPG's technicians are always ready to assist. We are eager to discuss the options with the customer to come to the best solution, whether it involves workshop repair, inspection rounds, or on-site maintenance.

Our service technicians are found on-site with our clients every day. Their task is to ensure that pumps and pumping systems receive preventive and corrective maintenance. They investigate malfunctions to subsequently resolve them.

ON-SITE INSPECTION ROUNDS

As previously emphasized, preventive maintenance and inspection of your system are crucial to keep the business system running as long as possible without surprises or potential downtime due to wear. "Prevention is better than cure." IPG's service technicians, experienced in many inspection rounds, will check all pumps, propellers, and mixers and provide a detailed report of their findings. Based on this report, we can advise you on maintenance, repair, or optimization possibilities for your system.





PUMP SCHOOL

IPG PUMP SCHOOL

The Industrial Pump Group's Pump School is a unique and valuable training opportunity for companies and individuals to gain the knowledge and skills necessary for working with industrial pumps. This school is designed to equip participants with practical and technical knowledge, enabling them to effectively troubleshoot and meet challenges in real-world applications.

IPG COURSES

The IPG Pump School offers not only a basic industrial pump training course but also various specialized courses focused on specific topics and skills. This range makes the IPG Pump School a comprehensive source of knowledge and expertise for both companies and individuals in the industry.

One such specialized course focuses on mechanical seals, which play a crucial role in preventing leaks in industrial pumps. Participants in this course will gain an understanding of different types of mechanical seals and learn the best practices for their installation and maintenance.

Furthermore, the Pump School offers a basic pumps course, concentrating on acquiring knowledge about various pumps, their application areas, and the fundamental principles of their operation. This course is perfect for newcomers to the industry who want to grasp the essential aspects of industrial pumps.

With this diverse course offering, the IPG Pump School stands as a valuable educational resource. Some examples of the courses IPG offers include:

- Basic Pump Knowledge
- Inspection and Maintenance
- Mechanical Seals
- Valves and Actuators
- Shafts and Bearings
- And many more...

SUSTAINABILITY AT IPG



CO2-NEUTRAL COMPANY PREMISES

At Industrial Pump Group (IPG), we are committed to sustainability in all areas. Our joint company premises with Microtechniek are not just a location; they are tangible proof of our commitment to environmental awareness. We proudly announce that our premises are entirely CO2-neutral, made possible by no fewer than 2350 solar panels on the roof, generating renewable energy. Our company premises serve not just as a functional workplace but also as a sustainable home for innovation.

SUSTAINABLE REPAIRS: REDUCE, REUSE, IMPROVE

IPG goes beyond environmentally friendly operations; we integrate sustainability into our core activities. Our pump repair capabilities are an essential part of our mission to reduce ecological impact. Whether dealing with centrifugal, multistage, split case, or progressive cavity pumps, our expert teams carry out repairs according to the highest VCA(**) guidelines. By reusing existing materials and components, we not only reduce waste and CO2 emissions but also provide sustainable solutions for the long term.

YOUR SUSTAINABLE PARTNER: IPG'S COMMITMENT TO A GREENER FUTURE

At IPG, sustainability is not an afterthought; it is at the heart of everything we do. Our CO2-neutral company premises illustrate our commitment to a greener future. With 2350 solar panels on the roof, we generate our own renewable energy and also reduce the overall costs of your pump maintenance. Choosing Industrial Pump Group means not only high-quality pump services but also partnering with a company that integrates sustainability into every aspect of its operations.

Dit gebouw
heeft energielabel

A+++++

G F E D C B A++++				
Isolatie		Installaties		Verbetering aanbevolen?
Gevels	<div><div></div><div></div><div></div><div></div><div></div></div>	Verwarming	Warmtepomp	<div><div>nee</div><div>ja</div></div>
Gevelpanelen	<div><div></div><div></div><div></div><div></div><div></div></div>	Warm water	Elektrische boiler	<div><div>nee</div><div>ja</div></div>
Daken	<div><div></div><div></div><div></div><div></div><div></div></div>	Ventilatie	Balansventilatiesysteem	<div><div>nee</div><div>ja</div></div>
Vloeren	<div><div></div><div></div><div></div><div></div><div></div></div>	Koeling	Compressiekoeling	<div><div>nee</div><div>ja</div></div>
Ramen	<div><div></div><div></div><div></div><div></div><div></div></div>	Verlichting	8.2 W/m² gemiddeld geïnstalleerd vermogen	<div><div>nee</div><div>ja</div></div>
Buitendeuren	<div><div></div><div></div><div></div><div></div><div></div></div>	Zonnepanelen	611.100 Wp	<div><div>nee</div><div>ja</div></div>

CERTIFICATIONS & QUALITY GUARANTEES



ISO 9001

IPG is proud to announce that we are ISO 9001 certified. This certification confirms our commitment to quality and customer satisfaction, and demonstrates that we meet international standards for quality management. At IPG, we believe that delivering high-quality services to our customers is of utmost importance, and achieving this certification is evidence of our level of dedication.



VCA** CERTIFICATION

With over 1.5 million certified professionals and 15,000 certified companies, VCA is the standard for safe, healthy, and sustainable working. VCA stands for Safety, Health, and Environment (SHE) Checklist Contractors. It is a proven program in which various sectors in the Dutch industry have combined 25 years of knowledge and experience. Companies with a VCA** certificate not only engage in safety, health, and environmental activities but also in policy, structure, and planning in the field of safety, health, and environment.



TRAINING COMPANY

In the industrial sector, skilled professionals will always be needed, and the future professionals are currently being prepared as students for the practical field. To teach these students the intricacies of the 'pump mechanic' profession, IPG offers itself as a training company.

Thus, the Industrial Pump Group contributes to the development of new, talented professionals for the future.



MEMBER METAALUNIE

Since 2014, the Industrial Pump Group Netherlands has been a member of the Royal Metal Union, the entrepreneurs' organization for small and medium-sized businesses in the Metal sector, which boasts over 15,000 members nationwide across sectors of Metal and technology.

The employees of the Metal Union collectively advocate for the interests of the SME-Metal and sectors directly related to Metal.



INDUSTRIAL PUMP GROUP

Concordiastraat 30
1951 AS Velsen - Noord, The Netherlands

TELEPHONE

+31(0)251 - 222 566

E-MAIL

info@industrialpumps.nl

WEBSITE

industrialpumps.nl